



#2202 – 608 Belmont Street, New Westminster, B.C.

Totals**

Main Level: 1,233 sq. ft.

Deck: 104 sq. ft.

Master Deck: 108 sq. ft.

Total: 212 sq. ft.

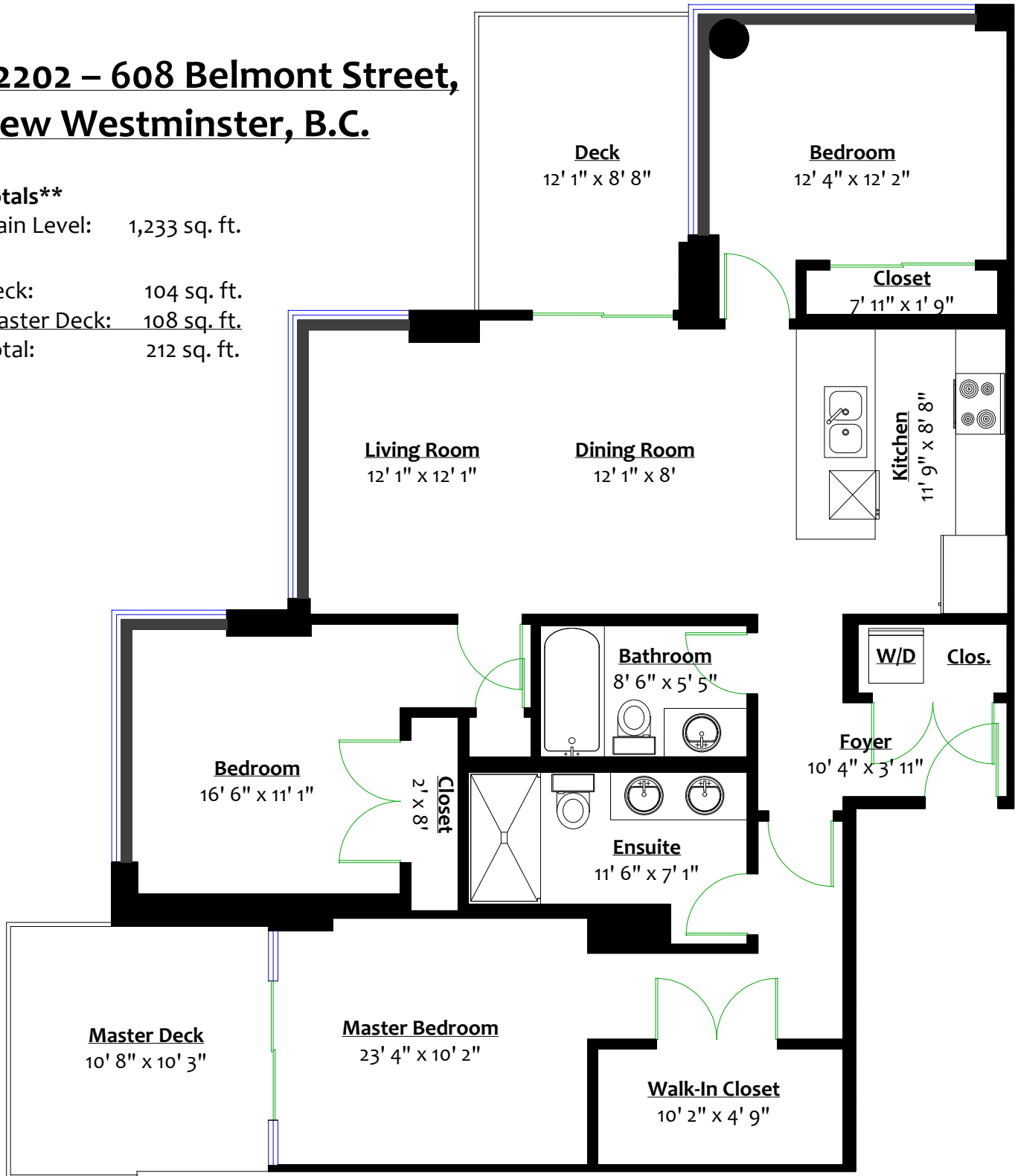

MAIN LEVEL

Floor Area: 000 Sq. Ft.

Ceiling Height: 0'

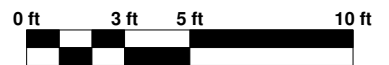

** While all reasonable attempts have been made to ensure accuracy and the square footage and room dimensions are believed to be correct to ANSI Standards, due to the possibility of human error the information cannot be guaranteed. E&O Insured for \$1,000,000