



TODD CONNER
 604.290.2269 **RE/MAX**
 All Points Realty
 info@toddconner.com

TH3 - 11 E Royal Avenue, New Westminster, B.C.

Totals**

Main Level:	704 sq. ft.	Deck:	57 sq. ft.
Upper Level:	765 sq. ft.	Patio:	124 sq. ft.
Top Level:	129 sq. ft.	Rooftop Deck:	595 sq. ft.
Lower Level:	770 sq. ft.		
Total:	2,368 sq. ft.	Total:	776 sq. ft.

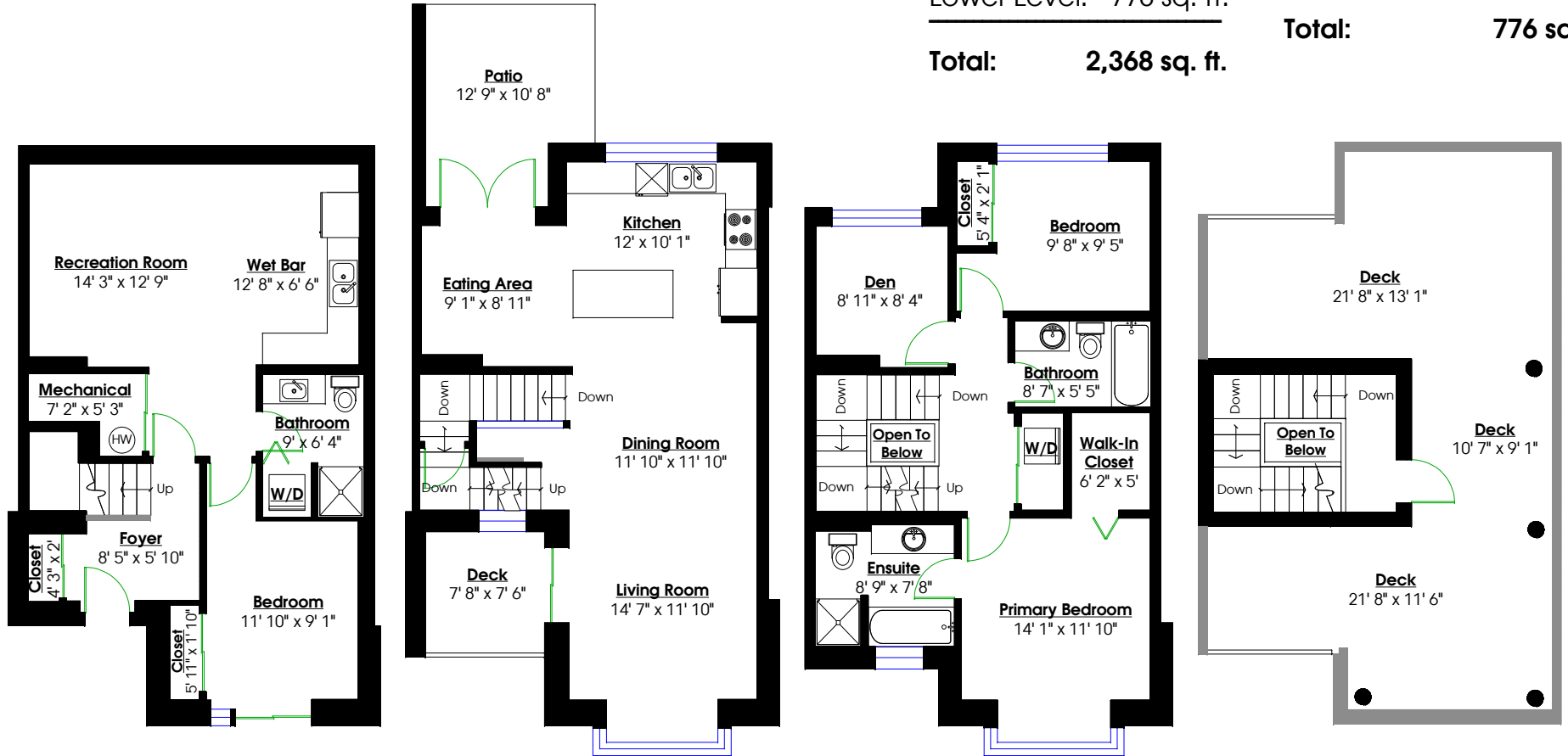

LOWER LEVEL
 Floor Area: 770 Sq. Ft.
 Ceiling Height: 9' 8"

MAIN LEVEL
 Floor Area: 704 Sq. Ft.
 Ceiling Height: 8' 8"

UPPER LEVEL
 Floor Area: 765 Sq. Ft.
 Ceiling Height: 8' 8"

TOP LEVEL
 Floor Area: 129 Sq. Ft.



** While all reasonable attempts have been made to ensure accuracy and the square footage and room dimensions are believed to be correct to ANSI Standards, due to the possibility of human error the information cannot be guaranteed. E&O Insured for \$1,000,000