

202-215 Mowat Street,  
New Westminster, BC

Total\*\*  
Main Level: 608 sq.ft.    Patio: 510 sq.ft.

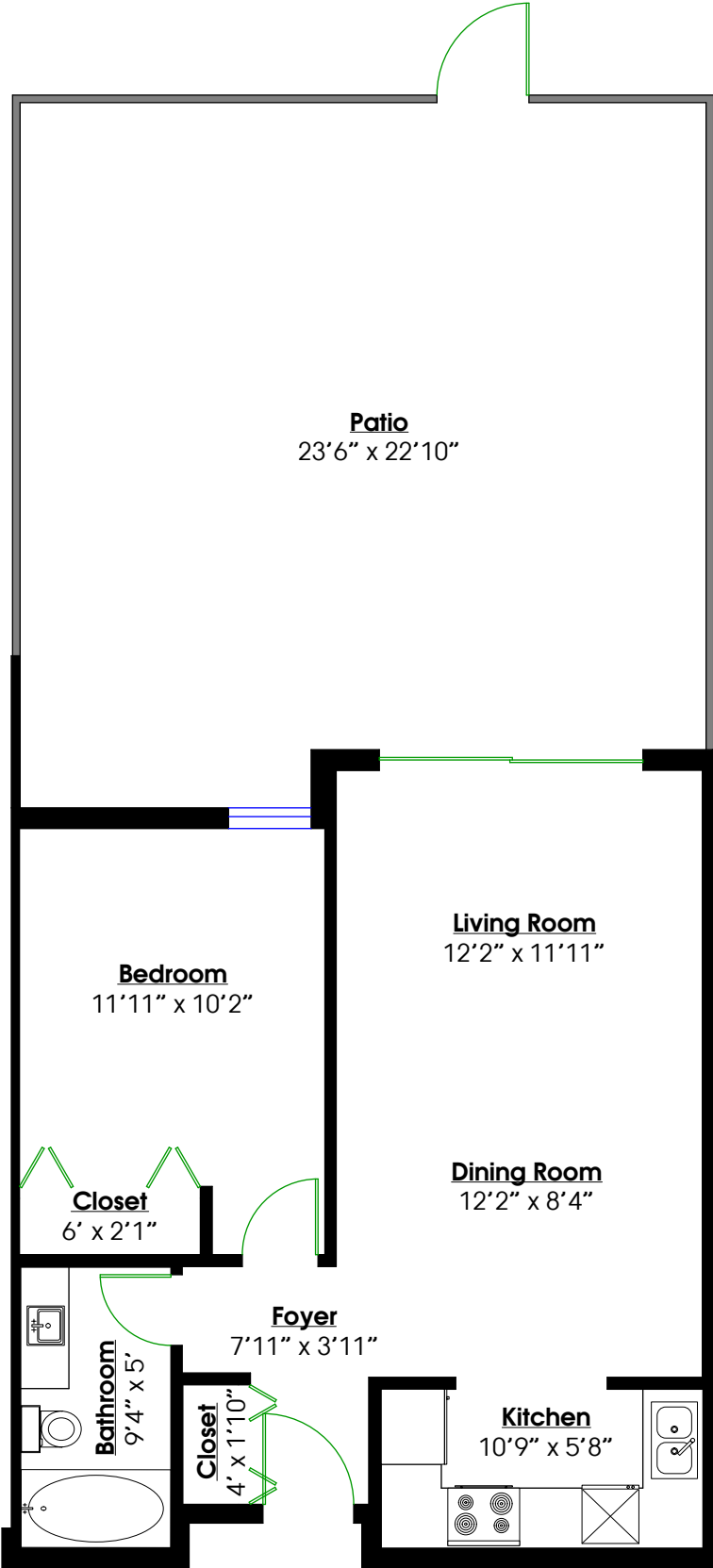

Todd & Karen Conner  
Your Favourite Real Estate Team  
604.290.2269 **REMAX**  
info@toddconner.com



**MAIN LEVEL**  
Floor Area: 608 Sq. Ft.  
Ceiling Height: 8'

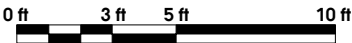

\*\*While all reasonable attempts have been made to ensure accuracy and the square footage and room dimensions are believed to be correct to ANSI Standards, due to the possibility of human error the information cannot be guaranteed. E&O Insured for \$1,000,000