

304-420 Carnarvon Street, New Westminster, BC

Total**

Main Level: 1,397 sq.ft. Deck: 88 sq.ft.



Todd & Karen Conner
Your Favourite Real Estate Team

604.290.2269 **REMAX**
info@toddconner.com

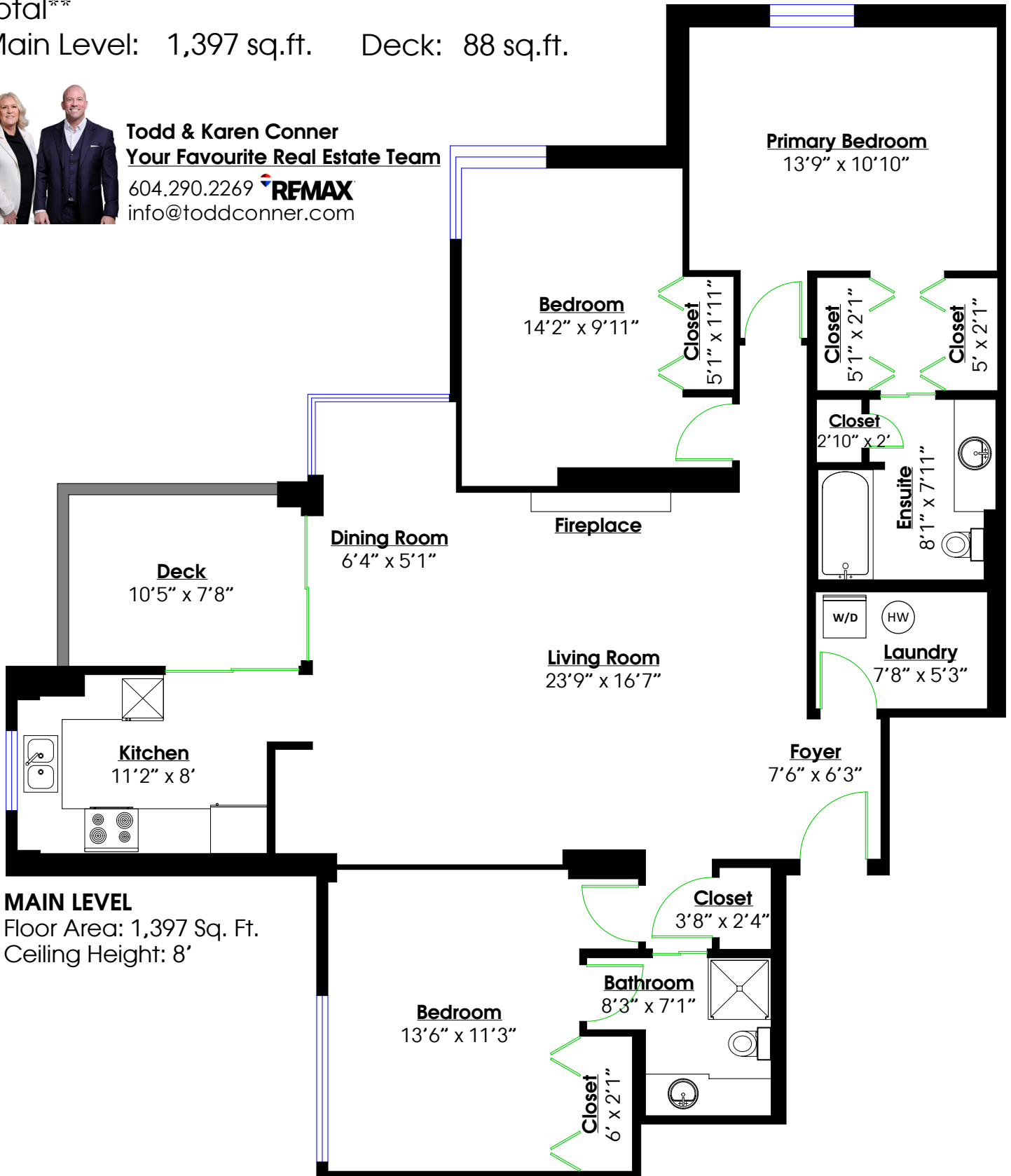

MAIN LEVEL

Floor Area: 1,397 Sq. Ft.
Ceiling Height: 8'

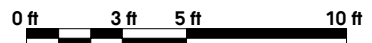

**While all reasonable attempts have been made to ensure accuracy and the square footage and room dimensions are believed to be correct to ANSI Standards, due to the possibility of human error the information cannot be guaranteed. E&O Insured for \$1,000,000